

TECHNICAL DOCUMENTS

MAZARIN M58 FERRY CATAMARAN

玛泽润 M58 双体高速客船

STANDARD SPECIFICATION

船艇标准配置



整体布局图

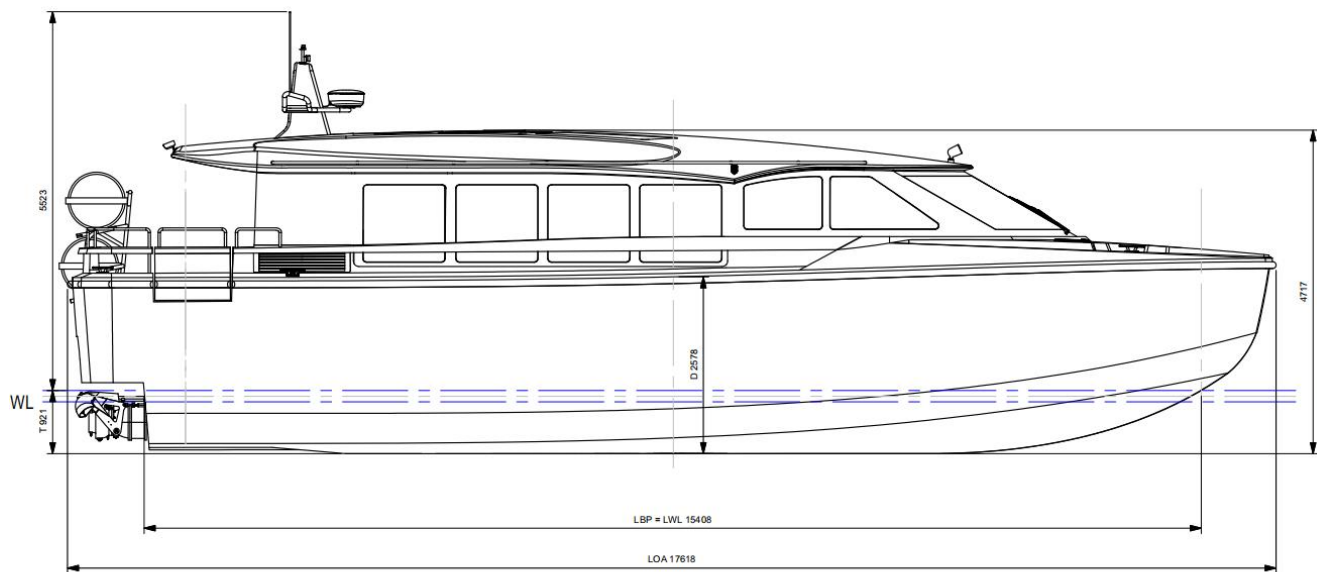

SIDE ELEVATION

侧视图

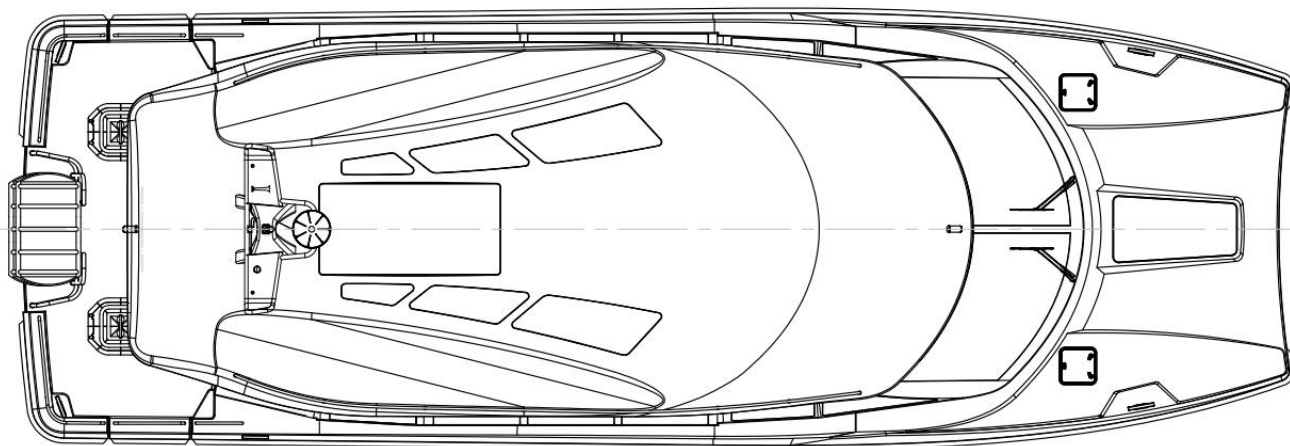

TOP VIEW

俯视图

[m]	OPERATING CON Significant Wave Height [r]
40.0	(1.12 / 35.9)
35.0	

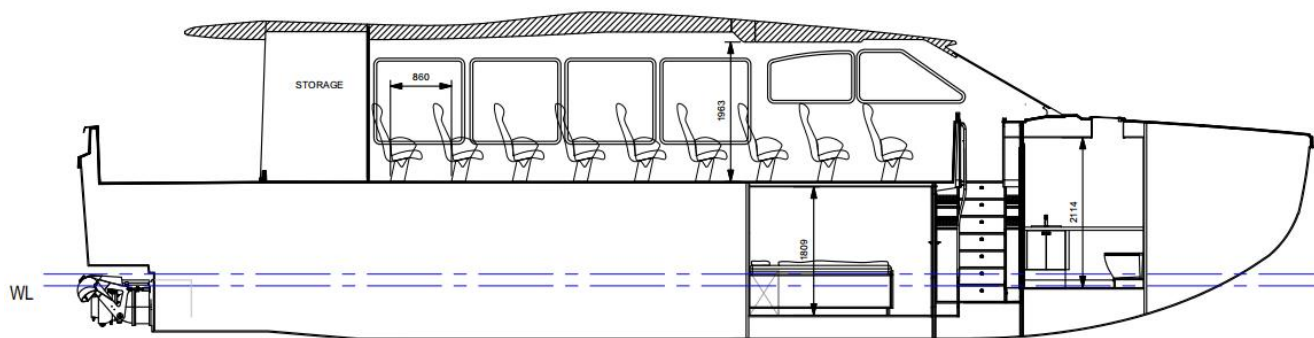

STAR BOARD SECTION
Y = -1.760mm

右舷剖面图
MAINDECK

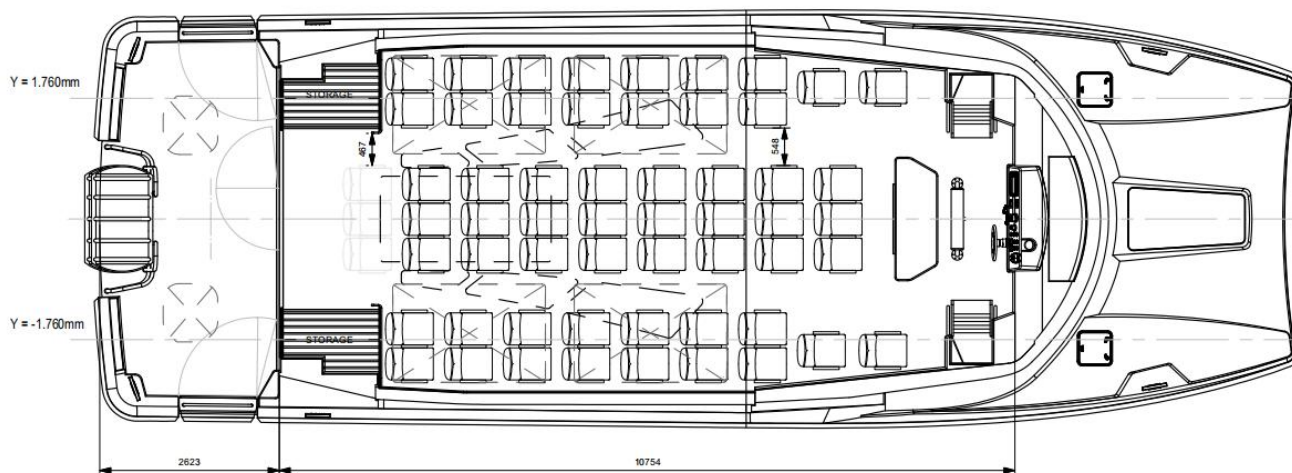

主甲板/沙龙

LOWER DECK

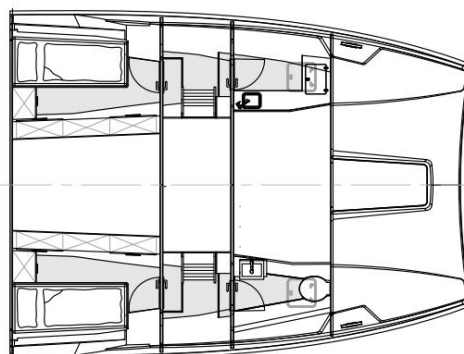

下舱

MAZARIN M58 FERRY Catamaran

Standard Specification 标准规范

Classification: ZC

等级: ZC

Technical Data 技术数据:

Length Overall 全长: 17.62M

Length of Waterline 水线长度: 15.41 M

Beam 最大宽度: 6.00 M

Draft Design 设计吃水: 0.92 M

Dry weight 轻载排水量: 24.00T

Full weight 满载排水量: 31.75T

Water tank capacity 淡水容量: 1*243 L

Black water 废水容量:1*61L

Fuel Capacity 燃料容量: 2*1250L

Capacity 人员数量: 56 位乘客+2 位船员

Propulsion : 动力系统

Main engine, shaft and propellers 发动机、大轴和螺旋桨: Catpillar C12.9 1000hp *2

Generator 发电机: Paguro 24KVA*1

MAZARIN M58 Ferry Catamaran

Standard Specification 标准规范

Construction 结构

GRP by vacuum infusion
真空吸附工艺制作玻璃钢
White gelcoat for hull and deck
船壳和甲板喷涂白色胶衣
Black anti-fouling under the water line
水线下方为黑色防污漆
Upper structure of the GRP hull
玻璃钢船体的上部结构
Watertight bulkheads, collision-compartments for safety
水密隔舱板和防撞舱提高了安全性
Black anti fouling at hull bottom
船底做黑色防污漆

Main deck and superstructure 主甲板和上建

Stainless steel guard rail and handrails at cockpit and superstructure roof
后甲板和上建屋顶的不锈钢栏杆和扶手
Rubber rubrail, black color
黑色橡胶护舷条
1*lift raft
1 个救生筏
2* openable side door with latches at cockpit
2 个后甲板可开侧门，带插销
2* watertight aluminium engine room deck hatch at cockpit
2 个铝制水密机舱舱盖，位于后甲板
2* stainless steel pollards
2 个不锈钢系缆桩
Black FLEXITEAK deck at cockpit
后甲板铺黑色 FLEXITEAK 人造柚木甲板
3* cockpit work lights

3 个后甲板工作灯
2* cockpit drains
2 个后甲板地漏
1* cockpit deck wash
1 个后甲板冲洗
1* fire hydrant and fire hose at cockpit
1 个消防栓和消防水带，位于后甲板
6* stainless steel cleats, 310mm
6 个不锈钢羊角，310MM 长度
6* stainless steel anti-chafing bar, 550mm
6 个不锈钢防摩擦条，550MM 长度
2* openable skylight hatch at foredeck
2 个可开天窗，位于前甲板
1* GRP chain locker with locks at foredeck
1 个玻璃钢锚链柜带锁舱盖，位于前甲板
1* anchor winch with foot switches, LEWMAR CPX4, 24V
1 个锚机，带脚踏开关，LEWMAR CPX4, 24V
1* hot galvanized anchor, 24KGS
1 个热镀锌锚，重 24 千克
1* hot galvanized anchor chain, 15M
1 根热镀锌锚链，15 米长
Anti-slip pattern for deck deck
前甲板做止滑面
Fixed superstructure glass and roof glass
固定式上建玻璃和天窗玻璃
1*GRP radar mast mount at roof
1 个玻璃钢雷达架，位于屋顶

Salon 沙龙区

1* aluminium water tight door to salon
1 个铝制水密沙龙艙门
2* stainless steel luggage racks
2 个不锈钢行李架
56* passenger seats with sliding rail, faux leather

56 个乘客座椅带滑轨，人造皮材质
1* salon wood cabinet for TV and main switch panel
1 个沙龙木制配电柜，放电视和主配电盘
1* stainless steel pole for helm
1 个不锈钢驾驶坐杆
1* GRP helm
1 个玻璃钢驾驶台
1* openable plastic hatch to the inner of salon helm
1 个可开塑料舱盖，通往沙龙驾驶台内部
1*TV
1 个电视
2* stairs with handrails to lower cabin
2 个通往下舱的楼梯，带扶手
Fusion audio system with 4 speakers
富声音响系统，带 4 个喇叭
Salon vinyl floor
沙龙乙烯基地板
4* Smoke detector
4 个烟雾报警器
20* ceiling lights
20 个天花灯
2* twin 230V socket and 2* twin USB socket
2 个 230V 双插插座和 2 个 USB 双插插座
4* portable fire extinguisher, 2kgs
4 个便携式灭火器，2 千克

STBD crew cabin 右水手房

Cabin door with lock
舱间门，带锁
Wrapped ceiling panels and wall panels
软包天花板和软包墙板
1* single bed with mattress
1 个单人床，带床垫
Storage space under the bed
床下有储物空间
1*Wardrobe
1 个衣柜
Air conditioner inlet and outlet, with control

panel
空调进出风口，带控制面板
1* Smoke detector
1 个烟雾报警器
3* Ceiling lights
3 只天花灯
1* reading lights
1 个阅读灯
1* 230V socket and 1* USB socket
1 个 230V 插座和 1 个 USB 插座
vinyl floor
乙烯基塑胶材质地板
Openable hatch to tank compartment
可开舱盖，通往箱体舱
1* portable fire extinguisher, 2kgs
1 个便携式灭火器，2 千克

STBD fore galley 右前厨房间

Cabin door with lock
舱间门，带锁
Ceiling panel in PU foam material
PU 发泡板天花
Man-made stone countertops
人造石厨房台面
vinyl floor
乙烯基地板
1*Stainless steel sink with water tap
1 个带水龙头的不锈钢洗菜盆
Storage cabinet
储物柜
2* stainless steel steps to climb out of the skylight hatch
2 个不锈钢踏步，通往天窗
1* top load cool box(owner supply)
1 个上开盖的冰盒（客供）
2* ceiling lights
2 个天花灯
1*AC 230V socket
1 个 AC 230V 插座

PORT crew cabin 左水手房

Cabin door with lock

舱间门，带锁

Wrapped ceiling panels and wall panels

软包天花板和软包墙板

1* single bed with mattress

1 个单人床，带床垫

Storage space under the bed

床下有储物空间

1*Wardrobe

1 个衣柜

Air conditioner inlet and outlet, with control panel

空调进出风口，带控制面板

1* Smoke detector

1 个烟雾报警器

3* Ceiling lights

3 只天花灯

1* reading lights

1 个阅读灯

1* 230V socket and 1* USB socket

1 个 230V 插座和 1 个 USB 插座

vinyl floor

乙烯基地板

Openable hatch to tank compartment

可开舱盖，通往箱体舱

1* portable fire extinguisher, 2kgs

1 个便携式灭火器，2 千克

PORT fore Bathroom 左前卫浴间

Cabin door with lock

舱间门，带锁

Ceiling panel in PU foam material

PU 发泡板天花

Vanity unit with man-made stone countertop

组合式梳妆盥洗台，配人造石台面

GRP floor with drain

玻璃钢地板带地漏

1* Wash basin with water tap

1 个带水龙头的洗脸盆

1*electric toilet

1 个电动马桶

2* stainless steel steps to climb out of the skylight hatch

2 个不锈钢踏步，通往天窗

Shower kits

淋浴花洒套件

Mirror

镜子

1*Strong extractor fan

1 个强力排气扇

2* ceiling lights

2 个天花灯

1*230V socket

1 个 230V 插座

Engine room and tank compartment 机舱和箱体舱

1* stainless steel ladder to each engine room

每个机舱配 1 个不锈钢梯子

2* engine room lights, 1 each

2 个机舱灯，每个机舱 1 个

Engine room is lined with insulation material

机舱做隔音棉

2* Catpillar C12.9 1000hp engines

2 台卡特彼勒发动机，1000 马力

2* exhaust system, Halyard

2 个排烟系统，HALYARD

2* engine room inlet blower

2 台机舱进风机

2* engine room outlet blower

2 台机舱出风机

4* fire damper

4 个风闸

4* engine room air grid

4 个机舱进出风格栅

2* gearbox ZF500

2 台 ZF500 齿轮箱

1* generator Paguro 24 KVA

1 台 24kw 意大利帕谷罗发电机
 2* sea water filter for main engine
 2 个发动机海水滤器
 1* sea water filter for generator
 1 个发电机海水滤器
 1* sea water filter for center water pump
 1 个中央消防海水泵滤器
 1* center water pump
 1 个中央消防海水泵
 2* Fixed fire fighting unit
 2 个机舱固定灭火器
 2* fire alarms
 2 个火警报警器
 2* customized shaft with aluminium protection cover
 2 根定制大轴，带铝合金保护罩
 2* customized bronze propellers
 2 个定制铜质螺旋桨
 1*Jefa steering system, with GRP rudder blades
 1 套丹麦 Jefa 舵系统，配玻璃钢舵叶
 2* tank compartment light, one each
 2 个箱体舱照明灯，每个舱间 1 个
 2*aluminium fuel tank, 1250L each
 2 个铝制油箱，1250L 每个
 2* fuel inlet, 38MM
 2 个注油口
 2* fuel water separator for main engines, GRIFFIN 1000MAM
 2 个油水分离器，用于发动机，GRIFFIN 1000MAM
 1* fuel water separator for generator, GRIFFIN 500MAM
 1 个油水分离器，用于发电机，GRIFFIN 500MAM
 1* fuel transfer pump between fuel tanks
 1 个输油泵，用于 2 个油箱之间
 1* plastic fresh water tank, 243L
 1 个塑料淡水箱，243 升
 1* fresh water pump, WHALE
 1 个淡水泵，WHALE
 1* fresh water deck inlet
 1 个淡水甲板注水口

1* plastic black water tank with pump, VETUS 61L
 1 个塑料黑水箱带泵，VETUS 61 升
 1* deodorizing filter
 1 个除臭滤器
 1* black water deck outlet
 1 个黑水甲板抽污口
 1* black water hull outlet
 1 个黑色船壳排污口
 All tanks with level sensor and display guages
 所有箱体都配液位传感器和液位仪表
 6*Jabsco Bilge pumps
 6 个 Jabsco 舱底泵
 6* Bilge alarms
 6 个舱底报警

Electric and navigation system 电路和导航系统

1*Air conditioning main unit, WEBASTO C108Q
 1 个空调主机，WEBASTO, C108Q
 1* sea water pump for AirCon
 1 个空调海水泵
 7* AirCon blowers
 7 个空调风机
 1* shore power socket and plug, 63A
 1 套岸电插座插头，63A
 1*Customized main electrical panel with acrylic cover
 1 个定制主配电板，带亚克力盖板
 1* customized switch panel
 1 个定制开关面板
 1* search light
 1 个探照灯
 7* Navigation lights
 7 个导航灯
 1* Compass
 1 个罗经
 2* Multi function display, Raymarine AXIOM 12
 2 多功能显示器，雷松 AXIOM 12

1*GPS, Raymarine
1 个 GPS, 雷松
1* Depth sounder, speed, wind sensor,
Raymarine
1 个测深测速测风, 雷松
1* VHF, Raymarine
1 个甚高频, 雷松
2* Catpillar engine display
2 个卡特彼勒发动机显示屏
1* throttle
1 个操车器
1* steering wheel
1 个舵轮
2* windscreen wipers
2 个雨刮器
2* charger
2 个充电器
1* VICTRON inverter
1 个 VICTRON 逆变器
3* Sail start battery 150AH
3 个风帆启动电池 150AH
4* Sail 200AH service battery
4 块风帆 24V200AH 服务电池
1* lightning rod
1 个避雷针
2* lightning plate
2 块避雷铜板
2* grounding plates
2 块接地铜板
2* zinc anodes
2 块防腐锌块

4 根系泊缆绳, 每根 20 米
Life saving equipment defined in ZC (life rings,
life jacket, flame signals, fire bucket, fire
fighters, EPIRB, search and rescue radar
transponder, ect.)
ZC 验船要求的其他救生装备 (救生圈、救生衣、
烟火信号、消防桶、手提灭火器、号型标、示位
标、雷达应答器等)

Miscellaneous 其他

Owner's manual
船主使用手册
Document box
游艇证明文件
6 cylinder fenders
6 个柱型防撞球
4 mooring rope 20 m ea.

**** All specifications subject to change without notice****

- the end -

Qualifications and Notice to Reader

Not included are pieces of free standing furniture and lamps, specified lighting, art work, cooking utensils, cutlery and flatware, soft goods and the design fees attendant to personalizing the Owners interior arrangement plan and design.

Performance statics, weight, draft, freeboard and height are estimated only and are not warranted, and actual figures will vary well as operational and sea conditions. Mazarin reserves the right to substitute equipment and materials stated herein to others which it believes to be of equal or superior quality and to make such design and dimensional changes as it believes are necessary to improve the vessel's performance and function. Special treatment of interior fit-out and/or use of non-standard soft furnishings required by the purchaser may subject to additional charge.

If the products brands mentioned above encounters abnormal long delivery terms then the builder is entitled to choose a similar brand which offers a shorter delivery term after the negotiation with the owner.

**** 如有变更，恕不另行通知 ****

- 结尾 -

注意事项

此标准规格仅包含标准室内布置所含对象。因买主喜好而采用之活动式家俱、灯具、设计师特别指定之照明器具、艺术品、灯具、餐盘、餐具、软件商品及室内设计师雇用费则需额外计费。

船舶性能、重量、吃水、乾舷及船高仅为预估值，船厂不予保证。实际数字取决於船舶建造之过程与安装之设备及存放位置，以及实际於海况中所取得之参数而异。

玛泽润保留采用替代设备和材料之权利，但会以等於或优於原始质量之方式，做出必要之设计或规格修改，以其提高船舶性能与功能。若买方需要特别之内部装修或使用非标准之软装饰等，玛泽润保留收取额外费用之权利。

以上所提及的品牌，在遇到该品牌交期太久的情况下，可以与船东商定更换类似交期短之类似品牌。