

## TECHNICAL DOCUMENTS

### MAVEA 49 SAILING CATAMARAN

MAVEA 49 双体帆船

STANDARD SPECIFICATION

竞速版标准配置



升帆效果仅供参考

## MAVEA 49 Sailing Catamaran

### Technical Data 技术数据:

Length Overall 全长:	15.33 M
Length of Waterline 水线长度:	14.95 M
Beam 最大宽度:	7.68 M
Draft Design 设计吃水:	0.57 M
Water Capacity 淡水容量:	2*340 L
Grey water 灰水容量:	190L
Black water 黑水容量:	2*100L
Fuel Capacity 燃料容量:	2*390L
Light displacement (EC)空载排水:	12.2 Tons
Mast Height 桅杆高度:	19.50 M
Main sail 主帆面积:	90 M2
SELF TACKING JIB 前帆	42 M2
Code 0 零号帆面积:	110M2(可选 optional)
Gennaker 球帆面积:	138M2 (可选 optional)
Sail dirve engine 主机:	2* 瑞典 Vovol D2-40 or similar
Generator 发电机:	1* 意大利 Paguro P10000 8KW or similar

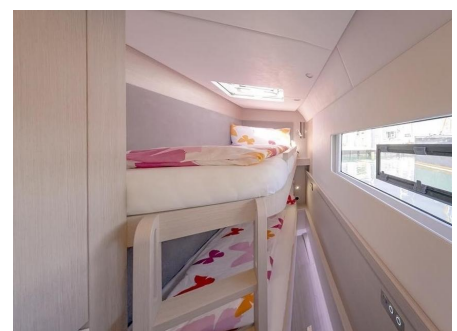
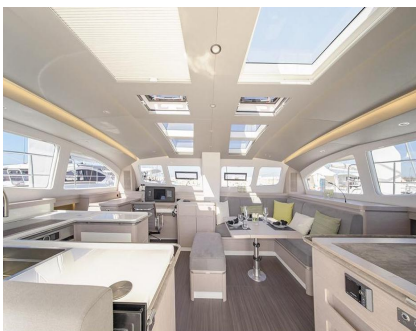

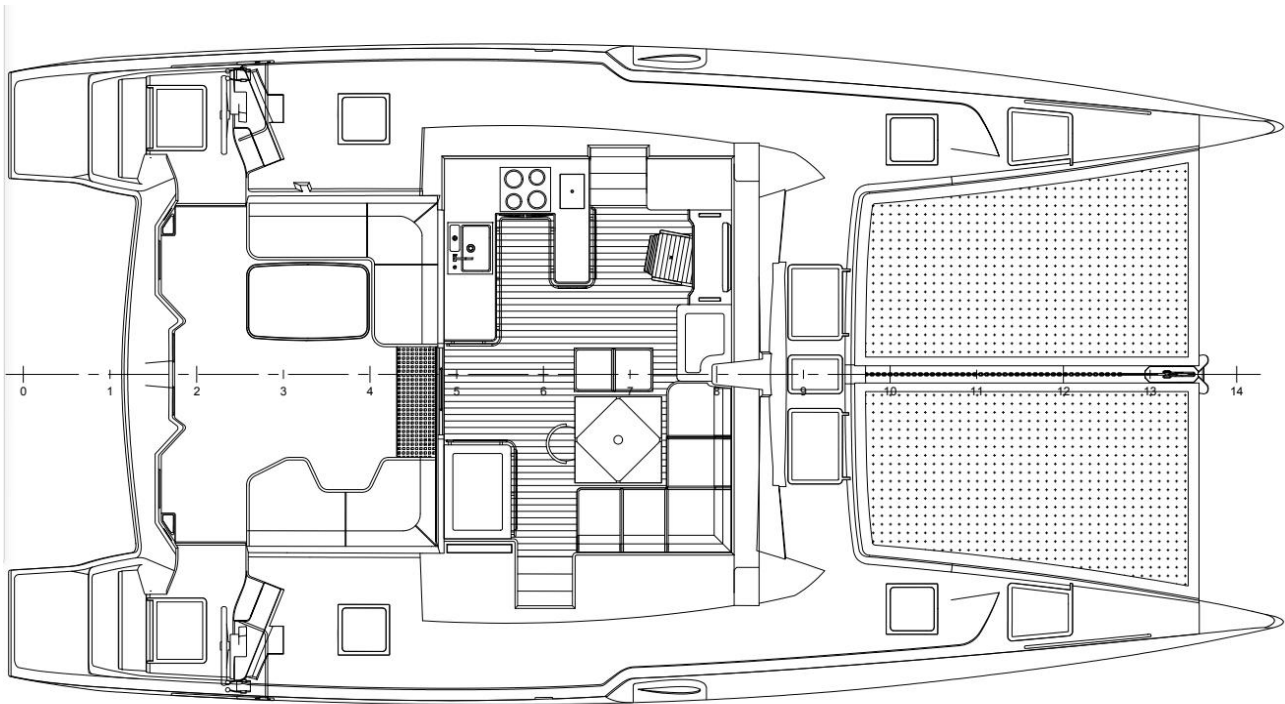

主甲板平面图

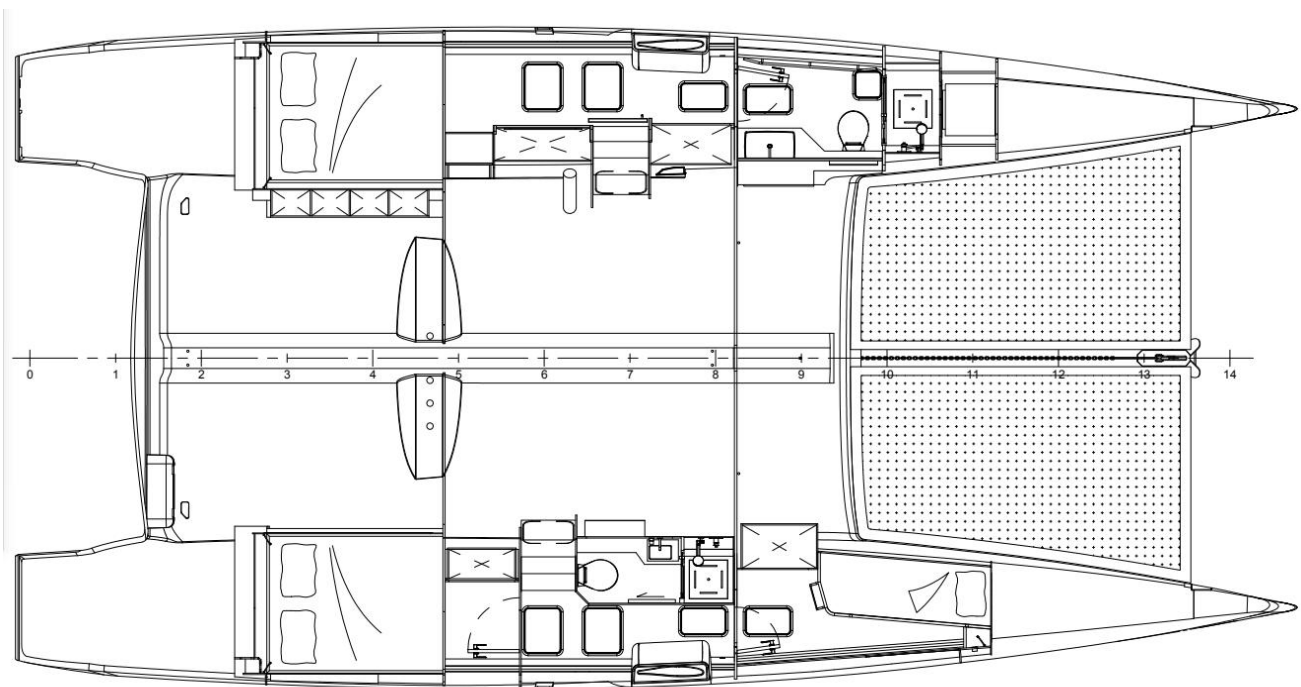

下舱甲板平面图

## **MAVEA 49 Sailing Catamaran**

### **Standard Specification 标准规范**

Classification: ZC

等级: ZC

### **Construction 结构**

GRP by vacuum infusion

真空吸附工艺制作玻璃钢

White gelcoat for hull and deck

船壳和甲板喷涂白色胶衣

Black anti-fouling under the water line

水线下方为黑色防污漆

Upper structure of the GRP hull

玻璃钢船体的上部结构

Hull which was reinforced by horizontal cabin and longitudinal wood floor

使用由横向舱壁和地板支持之纵梁加固船体

Watertight bulkheads, and collision-compartments for safety

水密隔舱板和防撞舱提高了安全性

Carbon fiber daggerboard

碳纤维稳向板

### **Main Deck 主甲板**

Stainless steel guard rail and handrails

不锈钢栏杆和扶手

10\*stainless steel cleats with anti-chafing bar

10 只不锈钢羊角, 带防摩擦条

Anti-skid for deck

甲板的止滑面

Port L-shaped sofa with cushions

左侧 L 型沙发, 带坐背垫

STB U-shaped sofa with cushions

左侧 U 型沙发, 带坐背垫

1\* cockpit table with fixed pedestals

沙龙后艄桌 1 套带固定支撑

Carbon fiber support for aft bimini\*2

碳纤维天花立柱 2 根

Cockpit hatches for engine room, with strong gas springs

后甲板机舱门，带强壮气撑 2 套  
GRP helm stations with steering wheels and folding SS seats \*2  
玻璃钢驾驶台，带舵轮和不锈钢折叠驾驶椅 双站  
2\* cockpit storage box  
后甲板储物盒 2 套  
Cockpit main control station\*1  
后甲板主操控台  
GRP tender davits  
玻璃钢小艇吊柱  
GRP compression beam \*1  
纵向撑杆 1 根  
Aluminium cross beam \*  
铝制横撑臂 1 根  
LEWMAR skylight hatch for side deck (with blinds and mosquito nets)\*4  
4 只英国 Lewmar 侧甲板的甲板天窗（含遮光+防蚊）  
Fore deck storage compartment \*2  
船首储物舱 2 个  
Bow peak sail locker \*2  
2 个船尖储帆舱  
LEWMAR CPX4 Anchor winch and 35kgs galvanized anchor  
LEWMAR CPX4 锚机和 35KGS 热镀锌锚  
Stainless steel anchor roller bracket  
不锈钢锚支架  
Galvanized anchor chain 50m  
50m 热镀锌锚链  
2\* trampoline  
2 个蹦床  
Aft bimini spot lights\*8  
后甲板天花照明灯 8 只  
Cockpit and transom floor lights\*10  
后甲板和船尾礼貌灯 10 只  
Tender lights \*5  
小艇灯 5 只  
Speakers at transom \*2  
船尾喇叭 2 只  
Subwoofer at stbd sofa\*1  
右沙发低音炮 1 套  
1\*Transom shower  
1 个船尾淋浴  
Deck wash fresh water  
甲板淡水冲洗



Water filler and fuel filler

注水口和注油口

Flagpole

旗杆

Drainage system

排水系统

### **Salon 沙龙区**

Stainless steel stern sliding door to salon

沙龙不锈钢滑动艉门

LEWMAR square openable porthole for front windows \*2

LEWMAR 长方形可开舷窗 2 个

Blinds for salon superstructure -made in China

沙龙上建窗帘-国产

Fixed glass around superstructure

上建配固定玻璃

Cabinets with drawers

抽屉柜

L shaped sofa with cushions

L 型沙发，带坐背垫

Folding table

折叠桌

Cabinets

储物柜

Nav. Table, with leathered instrument panel

导航桌，仪表板包皮

Leather wrapped SS handrail for cabinets

柜子上带包皮的不锈钢扶手

LG floor for salon

沙龙 LG 地板

1\* 43"TV, with up-down support

一台电视机带可伸缩支架

Wrapped wall panels and ceiling panels

墙面和天花软包

Speakers\*2

喇叭 2 个

Reading light \*1

阅读灯 1 个

6\* 230V sockets, 3\* 12V sockets

6 个 230V 插座，3 个 12V 插座

USB sockets\*3

USB 插座 3 个

Ceiling lights\*8

8 只天花板灯

2\*Nav. Spot lights

2 只导航桌区域的天花板灯

Interior LED stripe (warm white)

室内灯带（暖白）

Stairs with leather wrapped handrail to lower deck

通往下舱的楼梯，带不锈钢包皮扶手

Air conditioning GREE 16000BTU

格力空调 16000BTU

### **Galley 厨房**

Man-made stone countertops

人造石厨房台面

Cabinets with drawers

抽屉柜

40L Top load fridge\*1

上开门盒式冰箱 40L 1 台

1\*induction cooker with two heads

电磁炉 2 炉头 1 台

Siemens oven 45L\*1

微波炉烤箱一体机 1 台

Dometic extractor fan

吸油烟机 1 台

1\*Stainless steel sink with water tap

带水龙头的不锈钢洗菜盆

1\*DC 12V socket, 1\*AC 230V socket, 1\*USB

1 个 DC 12V 插座，1 个 AC 230V 插座，1 个 USB 插口

Galley spot lights\*4

4 只厨房天花板灯

LED light stripe for cabinets

柜子带 LED 灯带

### **Port aft Cabin 左后客房**

Sliding door

滑动门

**Queen size beds with mattress**

双人床，带床垫

**Storage space under the bed**

床下有储物空间

**Night stand**

床头柜

**2\* reading lights**

2 个阅读灯

**Wardrobe**

衣柜

**Air conditioning**

格力空调 9000BTU

**1\* 230V socket and 1\* USB socket**

1 个 230V 插座和 1 个 USB 插座

**6\*Ceiling lights**

6 个天花灯

**LED light stripe for wall**

墙面 LED 灯带

**Blinds**

窗帘

### **Port aft bathroom 左后客房卫浴间**

**Vanity unit with man-made stone countertop**

组合式梳妆盥洗台，配人造石台面

**1\* Wash basins**

1 个洗脸盆

**1\*electric toilet**

TMC 电动马桶

**Shower room with glass door**

淋浴室，带玻璃门

**Top quality sanitary accessories ( faucet, cup holder, towel rack, and shower kits )**

高品质洁具配件 (水龙头，置杯架，毛巾架以及淋浴套件等)

**Mirror**

镜子

**1\*Bathroom fan**

1 个排气扇

**1\*USB socket and 1\*230V socket**

1 个 USB 插座和 1 个 230V 插座

**3\*Ceiling lights**

3\*天花灯



LED light stripe for wall

墙面 LED 灯带

Washing machine compartment with shelves

洗衣机舱，带置物层板

1\*washing machine

1 台洗衣机

Blinds

窗帘

### **STBD aft Cabin 右后客房**

Queen size bed with mattress

双人床，带床垫

Storage space under the bed

床下有储物空间

2\* reading lights

2 个阅读灯

Wardrobe

衣柜

Air conditioning

格力空调 9000BTU

1\* 230V socket and 1\* USB socket

1 个 230V 插座和 1 个 USB 插座

5\* Ceiling lights

5\* 天花灯

Blinds

窗帘

### **STBD Guest Bathroom 右客房卫浴间**

Sliding door

滑动门

Vanity unit with man-made stone countertop

组合式梳妆盥洗台，配人造石台面

1\* Wash basins

1 个洗脸盆

1\*electric toilet

TMC 电动马桶

Shower room with glass door

淋浴室，带玻璃门

Top quality sanitary accessories ( faucet, cup holder, towel rack, and shower kits )

高品质洁具配件 (水龙头, 置杯架, 毛巾架以及淋浴套件等)

**Mirror**

镜子

**1\*Bathroom fan**

1 个排气扇

**1\*USB socket and 1\*230V socket**

1 个 USB 插座和 1 个 230V 插座

**2\*Ceiling lights**

2\*天花灯

### **STBD fore Cabin 右前客房**

**Bunker beds with mattress**

上下单人床, 带床垫

**Storage space under the bed**

床下有储物空间

**Night stand**

床头柜

**2\* reading lights**

2 个阅读灯

**Wardrobe**

衣柜

**Air conditioning**

格力空调 9000BTU

**1\* 230V socket and 1\* USB socket**

1 个 230V 插座和 1 个 USB 插座

**2\* Ceiling lights**

2\* 天花灯

**Blinds**

窗帘

### **Engine Room and bilge 机舱和舱底**

**2\* VOLVO PENTA D2-40 or similar brand**

2 台 VOLVO 帆船机 D2-40 或同等马力同级别品牌

**1\* Generator Pauguro 8 KW or similar brand**

1 台意大利帕谷罗发电机 8KW

**Engine room insulation**

机舱隔音

**2\*Engine room lighting**

2 个机舱灯

JEFA rudder mechanical system

JEFA 机械操舵系统

4\* auto bilge pumps, and 1 manual bilge pump

4 个自动舱底泵, 1 个手动舱底泵

Bilge alarms

舱底报警

2\* 100L black water tank

2 个 100L 黑水箱

Water boiler\*1

热水器 20L

### **Electric and Navigation System 电气和导航系统**

Main switch panel

主配电盘

Battery switch panel

电池开关面板

Shore power socket and cable with plug

岸电插座, 岸电电线带插头

Charger\*2

充电器 2 个

VICTRON QUATTRO 24/5KVA/120-100 230V \*1

VICTRON 逆变器 1 台

Sail start battery 80AH for engines \*2

风帆启动电池 80AH, 用于发动机 2 块

Sail start battery 80AH for generator \*1

风帆启动电池 80AH, 用于发电机 1 块

Sail 200AH service battery\*2

风帆 200AH 服务电池 2 块

Grounding plates

接地铜板

Zinc anodes

防腐锌块

Navigation system: Raymarine or B&G

导航系统品牌: 英国 Raymarine/瑞典 B&G

Charter plotter\*2 -9 inch

海图仪 2 个 9 英寸

1\*radar system

1 个雷达系统

VHF\*1

甚高频 1 套

1\* AIS+GPS

1\* Speed / Depth / Wind pack

测深测速系统

1\* electric horn

1 个电笛

**Mast, Sails and Rigging 桅杆和支索系统 Selden 品牌**

1\* aluminium mast 19.50M

铝合金主桅杆 19.5 米

1\* aluminium boom

铝合金横帆杆

1\* main sail 90 SQM

主帆 90 平方

1\* self-tacking jib 42 SQM

自动转舷前帆 42 平方

1set\* STANDING RIG

1 套固定支索

3\* halyard

3 根升帆索

4\* sheets

4 根缭绳

Other ropes

其它绳索

**Winches and deck gear 绞盘和甲板五金-Antal or similar brand**

2\* electric winch 52ST

2 个电动绞盘 意大利 ANTAL

2\* electric winch 50ST

2 个电动绞盘 意大利 ANTAL

1\* manual winch 46ST

1 个手动绞盘 意大利 ANTAL

Main sheet track with traveler cars and blocks

主帆滑轨，带滑车和滑轮

Self-tacking jib track with traveler cars and blocks

自动转舷前帆滑轨，带滑车和滑轮

Fixed halyard blocks, rope glide rings, blocks, pad eyes

固定式升帆索滑轮、过绳孔、滑轮、眼板

27\* SPINLOCK rope clutches

27 个夹绳器 英国 Spinlock

**Miscellaneous 其他**

Owner's manual

船主使用手册

Document box

游艇证明文件

**\*\* All specifications subject to change without notice\*\***

- the end -

### **Qualifications and Notice to Reader**

Not included are pieces of free standing furniture and lamps, specified lighting, art work, cooking utensils, cutlery and flatware, soft goods and the design fees attendant to personalizing the Owners interior arrangement plan and design.

Performance statics, weight, draft, freeboard and height are estimated only and are not warranted, and actual figures will vary well as operational and sea conditions. Mazarin reserves the right to substitute equipment and materials stated herein to others which it believes to be of equal or superior quality and to make such design and dimensional changes as it believes are necessary to improve the vessel's performance and function. Special treatment of interior fit-out and/or use of non-standard soft furnishings required by the purchaser may subject to additional charge.

**\*\* 如有变更，恕不另行通知 \*\***

- 结尾 -

### **注意事项**

此标准规格仅包含标准室内布置所含对象。因买主喜好而采用之活动式家俱、灯具、设计师特别指定之照明器具、艺术品、灯具、餐盘、餐具、软件商品及室内设计师雇用费则需额外计费。

船舶性能、重量、吃水、乾舷及船高仅为预估值，船厂不予保证。实际数字取决於船舶建造之过程与安装之设备及存放位置，以及实际於海况中所取得之参数而异。

玛泽润保留采用替代设备和材料之权利，但会以等於或优於原始质量之方式，做出必要之设计或规格修改，以其提高船舶性能与功能。若买方需要特别之内部装修或使用非标准之软装饰等，玛泽润保留收取额外费用之权利。